



CLAVIS®

Der Schlüssel für Ihren Wertschutz



•ISO 9001
•Service-Unternehmen
für Wertbehältnisse

Kaba Mauer Code-Combi B Operation Instructions - Summary

KABA®
MAUER



CLAVIS Deutschland GmbH
Grüner Weg 38
34117 Kassel

Telefon: +49 (0)561 988 499-0
E-Mail: info@tresore.eu
Internet: www.tresore.eu
www.tresorschloss.de

1 Working instructions



These instructions serve to impart the first basic functions. They do not replace the complete operating instructions. If during the operation signals are shown which are not described in these instructions, please consult the complete operating instructions.



Please keep the revision key at a safe place, but not in the same safe. If the numeric code is not available or the electronic function is not possible, the key allows a purely mechanical opening. If the lock is opened, the key also makes an alteration of opening code (primary code) possible in case the opening code is not available anymore.

2 Signals and what they mean

Plastic input unit:

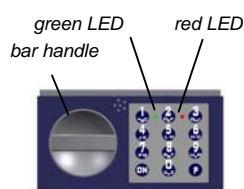

Aluminium input unit:



Combined fitting with hinged handle:

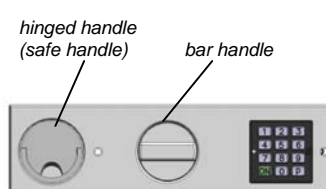

Combined fitting with lever handle:



Fig. 1: Input units

Symbol	Signal	Meaning
1 x	Green LED flashes once	Valid 6-digit code entered
	Green LED remains lit up	Lock is ready for programming
3 x	Red LED flashes 3 times	Misentry
10 x	Red LED flashes 10 times after ON button pressed	Insufficient voltage of the battery
1, 2, 4, 8 or 16 minutes	Red LED flashes every second for 1, 2, 4, 8 or 16 minutes after 3 or more incorrect code entries	Lock is in blocked status
	Red LED flashes every 5 seconds	Lock is in time delay status
3 x	Red and green LED flash alternately 3 times	Lock was last opened with another code
/	Red and green LED flash accompanied by an acoustic signal	Plastic control unit: cover plate removed for key opening Aluminium control unit: battery compartment lid was opened to change batteries or attempt to tamper with lock (dismantling of the input unit)
/	Green LED flashes every 5 seconds accompanied by an acoustic signal	Lock is in opening window status

1 x	Acoustic signal sounds once	E.g. end of opening window period
2 x	Acoustic signal sounds 2 times	E.g. during programming new 6-digit code entered
3 x	Acoustic signal sounds 3 times	E.g. during programming invalid 6-digit code entered

3 Opening

	With works code "123456"	With personal code "*****"	
1)	Press ON	Press ON	
2)	Enter works code	Enter personal primary or secondary code	1 x
3)	Within 4 seconds turn bar handle clockwise until stop position is reached 	Within 4 seconds turn bar handle clockwise until stop position is reached 	

The lock is set at the works code **1 2 3 4 5 6** when supplied. Alter this immediately to your own personal code for security reasons. Do not use any personal or other similarly well known data (for example birthdays) when selecting this code.

In conjunction with a bolt work: after the lock has been opened ①, the mechanic of the bolt work must be opened ②. Therefore the corresponding safe handle must be used.

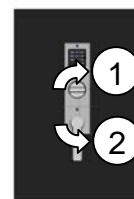

4 Alteration of primary code

The lock should only be programmed with the lock and safe opened. The newly programmed code should be tested at least twice with the safe opened.

	Alteration of works code to personal primary code	Alteration of personal primary code	
1)	Open the lock with the works code (see 3 or complete operating instructions 4.1.1)	Open the lock with the personal primary code (see 3 or complete operating instructions 4.1.1)	
2)	Press ON	Press ON	
3)	Press P	Press P	
4)	Enter the works code "123456"	Enter personal primary code "*****"	
5)	Enter new 6-digit primary code	Enter new 6-digit primary code	/ 2 x
6)	Enter new 6-digit primary code again	Enter new 6-digit primary code again	1 x
7)	Test newly programmed primary code by locking and opening once more	Test newly programmed primary code by locking and opening once more	

5 Switching on of secondary code

1)	Open lock with valid 6-digit primary code (see 3 or complete operating instructions 4.1.1)	
2)	Press ON	
3)	Press P	
4)	Enter valid 6-digit primary code	⊙
5)	Press P	⊙
6)	Press 3	⊙
7)	Enter new 6-digit secondary code	⊙ / 2 x ⏪
8)	Enter new 6-digit secondary code again	1 x ⊙
9)	Test newly programmed secondary code by locking and opening once more	

6 Cancellation of secondary code

1)	Open lock with valid 6-digit primary code (see 3 or complete operating instructions 4.1.1)	
2)	Press ON	
3)	Press P	
4)	Enter valid 6-digit primary code	⊙
5)	Press P	⊙
6)	Press 0	1 x ⊙

By pressing the key combination **P** and **0** all the functions programmed (secondary code, dual code, time delay and opening window) are deleted.

7 Locking

In conjunction with a bolt work: after the door has been closed, the bolt work must be blocked ① and the lock must be closed ②.

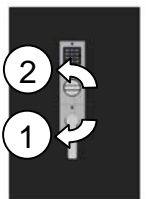

1)	Turn bar handle counter clockwise until stop position reached	
----	---	--



For further functions and important points, please have a look at the complete operating instructions.